

Plat of Survey

of

Tax Parcel F D 2200006

A parcel of land located in the Northeast 1/4 of Section 22, Town 2 North, Town 16 East, Delavan, Walworth County, Wisconsin, as described in a Warranty Deed recorded in Vol.644 of Deeds on Page 104 as Document No. 342153 as shown below:

A parcel of land located in the NE 1/4 of fractional Section 22-2-16 East, Walworth County, Wisconsin, described as follows, to-wit: Commencing at the E 1/4 Section corner of said Section 22; thence West along the 1/4 section line, 38.14 feet to the place of beginning; thence continue West on the 1/4 section line 191.71 feet to a point in the centerline of State Trunk Highway #50; thence North 29°20' West along said centerline 106.29 feet to a point; thence North 38°43' East 198.87 feet to a point; thence South 25°45' East 274.91 feet to said 1/4 section line and the place of beginning. Said land being in the Town of Delavan.

Tax Parcel F D 2200007

A parcel of land located in the Northeast 1/4 of Section 22, Town 2 North, Town 16 East, Delavan, Walworth County, Wisconsin, as described in a Warranty Deed recorded in Vol. 630 of Deeds on Page 5127 as Document No. 286479 as shown below:

Beginning at the East 1/4 corner of the Fractional Section 22 T2N, R16E, East, Walworth County, Wisconsin; run thence West on the South line of the NE 1/4 of said Section 22, 220.85 feet to a point in the centerline of State Trunk Highway #50; thence North 29°20' West along the centerline of State Trunk Highway #50, 106.29 feet to a point, said point marks the place of beginning of the parcel of land herein after described; thence continue North 29°20' West along the centerline of State Trunk Highway #50, 223.88 feet to a point; thence North 65°13' East 193.40 feet to a point; thence South 25°45' East 134.86 feet to a point; thence South 38°43' West 198.87 feet to a point and the place of beginning. Said land being in the Town of Delavan.

Note: Easement shown is taken from previous survey. Refer to a current Title Commitment for a complete list of easements which affect these sites.

Surveyed for: Hwy. 50 Real Estate Investment, LLC
W3923 Lake Forest Lane
Lake Geneva, Wisconsin. 53147

Lot 1
WESTSHIRE FARMS at the LAKES

Lot 1
C.S.M. 312

Town of Delavan
Fire Department
Station No. 1
5698 1/2 Town Hall Road

Benchmark
East 1/4 Corner
Section 22-2-16
N. 228.691 55
E. 3385.167 65
Elevation=949.58

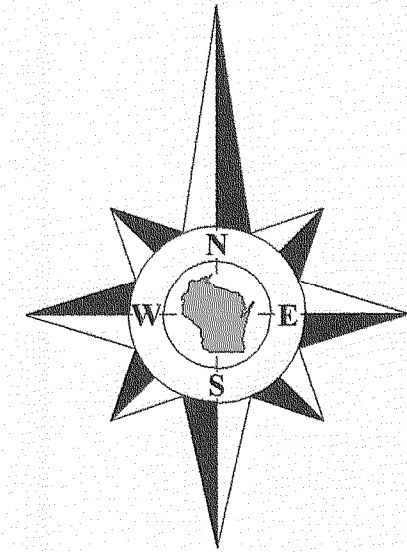

Bearings referenced to
Previous Survey

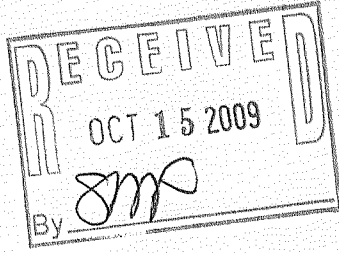
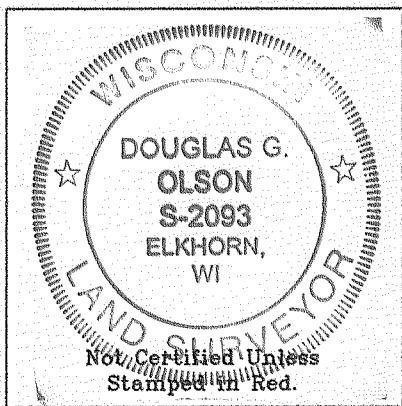

Notes: 1) This survey plat is not certified unless signed and sealed in red ink.
2) This survey is subject to Wisconsin lien laws. This Plat of Survey is the notice of intent to file lien. Lien waiver required.

Copyright 2003 by Jensen & Olson Land Surveying, LLC.

All rights reserved. No part of this survey plat may be reproduced or transmitted in any form by any means - graphic, electronic, or mechanical, including photocopying, tracing, or information storage and retrieval systems - without permission in writing from Douglas G. Olson, Jensen & Olson Land Surveying, LLC.

I, Douglas G. Olson, Wisconsin Registered Land Surveyor, do hereby certify that this survey was performed by me or under my direction in full compliance with the owner's/agent's instructions and Chapter A-E 7 of the Wisconsin Administrative Code "Minimum Standards for Property Surveys", and that this map is an accurate representation thereof to the best of my knowledge and belief.

Douglas G. Olson
Wisconsin Registered Land Surveyor - 2083

Sheet 1 of 1 Sheets.

Job Reference Number
2009.055

Legend

- Found County Section Corner
- Found Iron Pipe
- Found Iron Rod
- Found P.K. Nail
- Recorded Information
- Monitoring Well
- Fence
- Utility Pole
- Utility Pedestal
- Traffic Signal
- Metal Cover Round
- Concrete Surface
- Asphalt Surface
- Gravel Surface
- Bollard
- PVC Pipe
- Manhole
- Square



Jensen & Olson Land Surveying, LLC

45 South Wisconsin Street * P.O. Box 322 * Elkhorn, Wisconsin. 53121
Telephone: (262) 723-3434 * Facsimile: (262) 723-8044
Email: jensen.olson@elknet.net

Scale in Feet

1" = 20'



Survey date: July 10, 2003.

Revisions: No. 1 - New pumps, canopy & building

FD22-7 FD22-8

216-4682